

Census Seminar Series

*2006 Census of Population and
Dwellings*

Overview

- Official Statistics System
- Introduction to census
- What we look like nationally
- What we look like locally
- Population estimates and projections
- Break
- What's available and how to access it

What is the Official Statistics System?

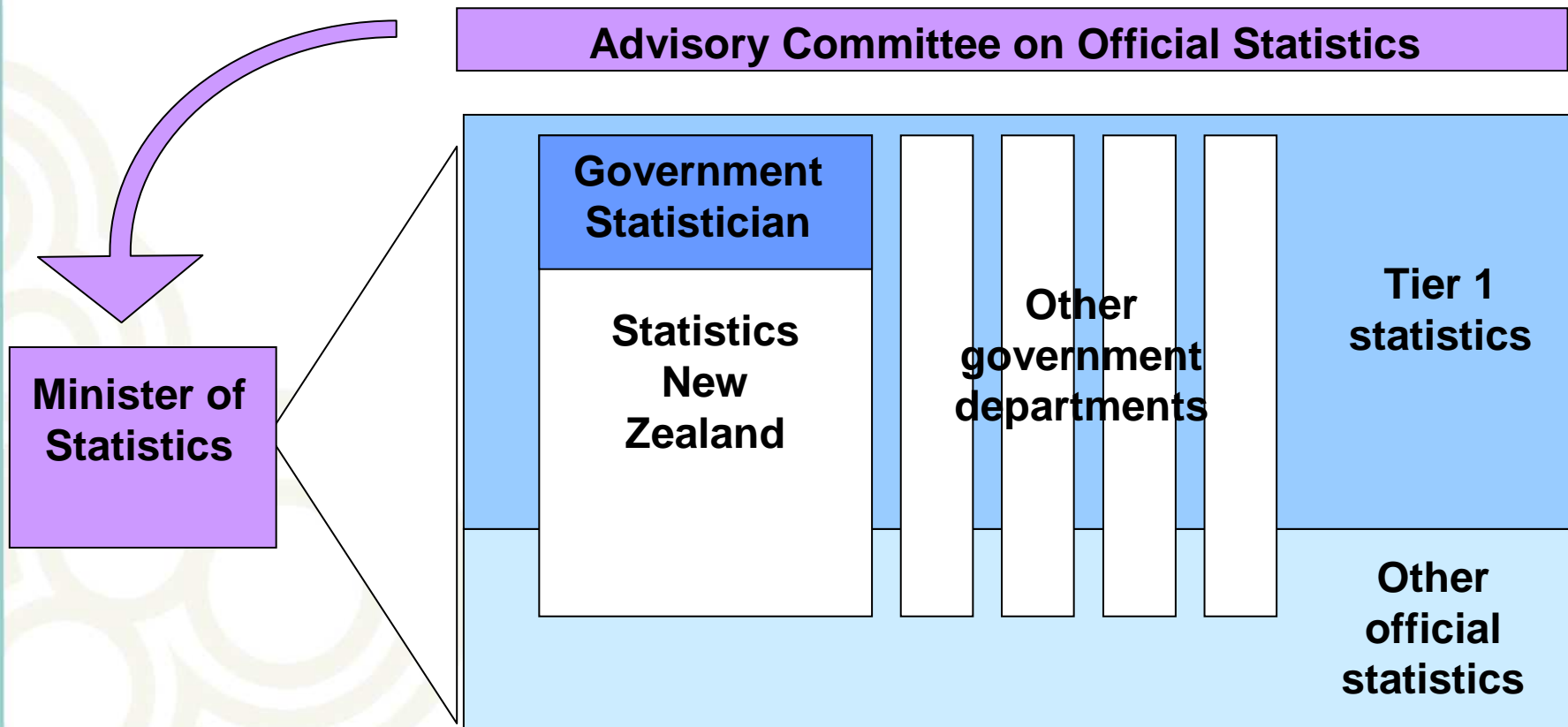

Population measures

- Census night population count
- Census usually resident population count
- Estimated resident population
 - o net census undercount
 - o residents temporarily overseas on census night
- Projected population

Introduction to the census



Statistics Act 1975

The 1975 Statistics Act requires that the Census of Population and Dwellings be taken every five years and is also used in redefining our electoral boundaries



Confidentiality

We have a legal requirement to protect the confidentiality of all statistical data

Confidentiality involves:

- Keeping responses confidential
- Having clear rules for release of data so that no individual can be identified
- Maintaining public goodwill and trust
- Balancing this, we endeavour to make as much small area data available as possible

Topics in the census

- Demography
- Geography
- Ethnicity & culture
- Income
- Work
- Housing
- Transport
- Household communications
- Health

Advantages of the census

- Counts everyone in New Zealand on census night (including visitors)
- Provides information about small areas and populations
- Allows the combination of information
- Measures change over time (five-yearly cycle)

Limitations of the census

- Questionnaire is self-completed
- Cannot measure complex or sensitive information
- Will not determine underlying causes of trends or events
- Time delay in providing accessible data

Our building blocks

- New Zealand
- Regional council area
- Territorial authority
- Area unit
- Meshblock

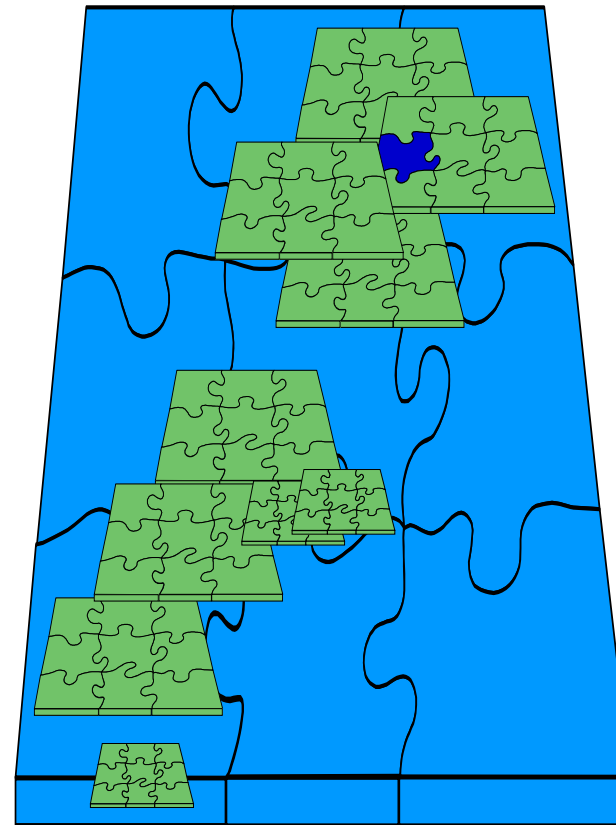

Regional council area

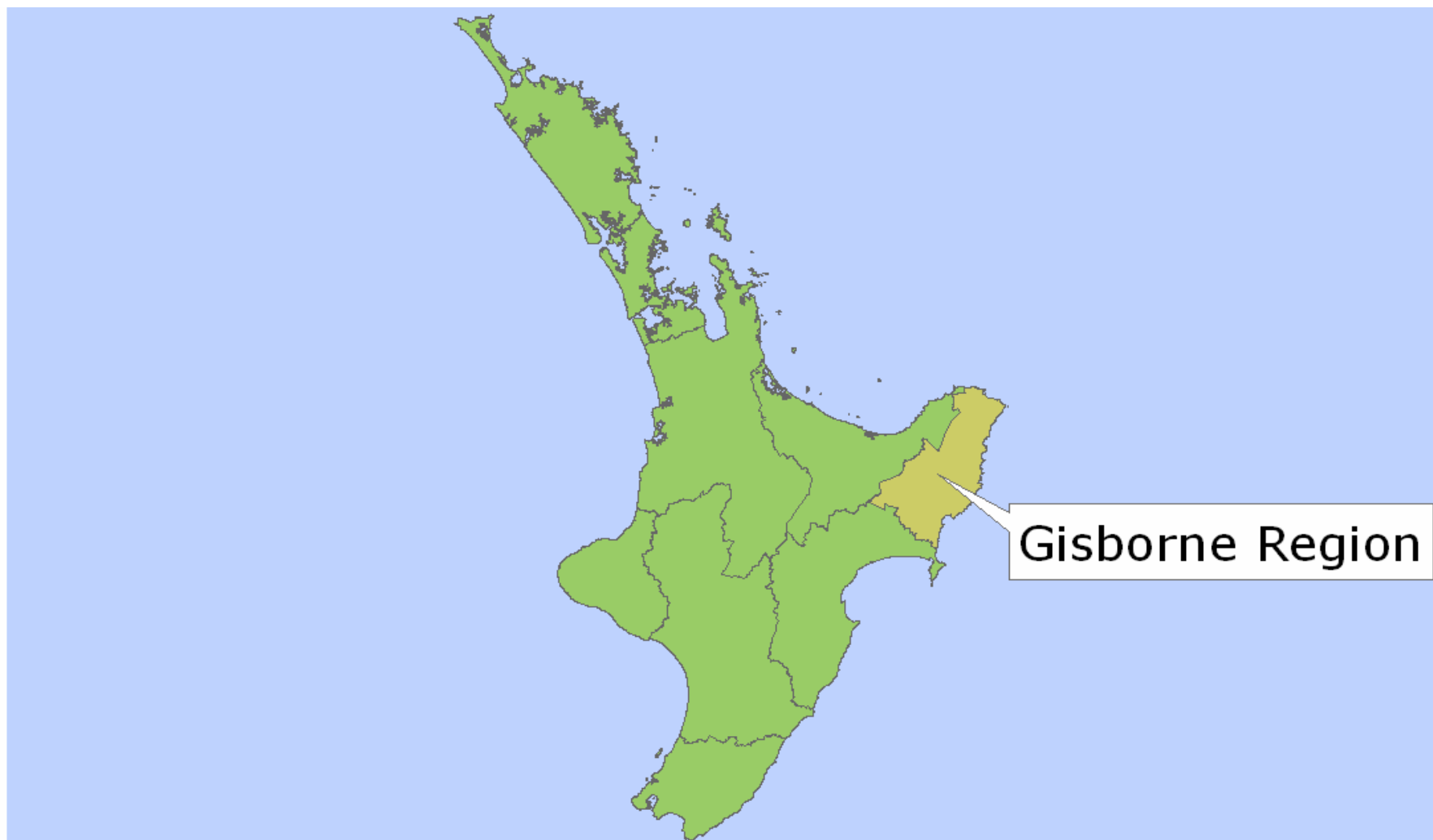

Territorial authority

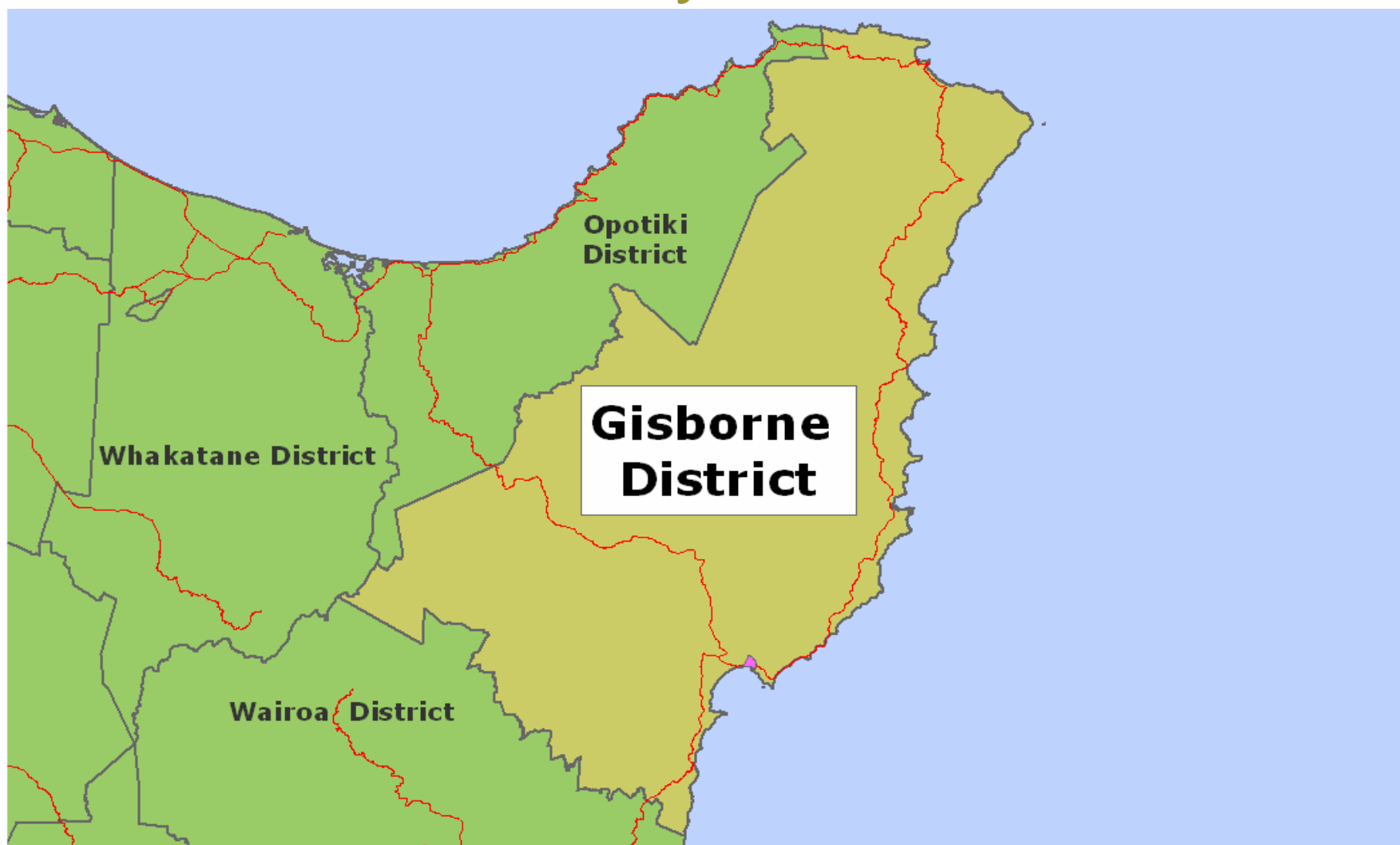

Area unit

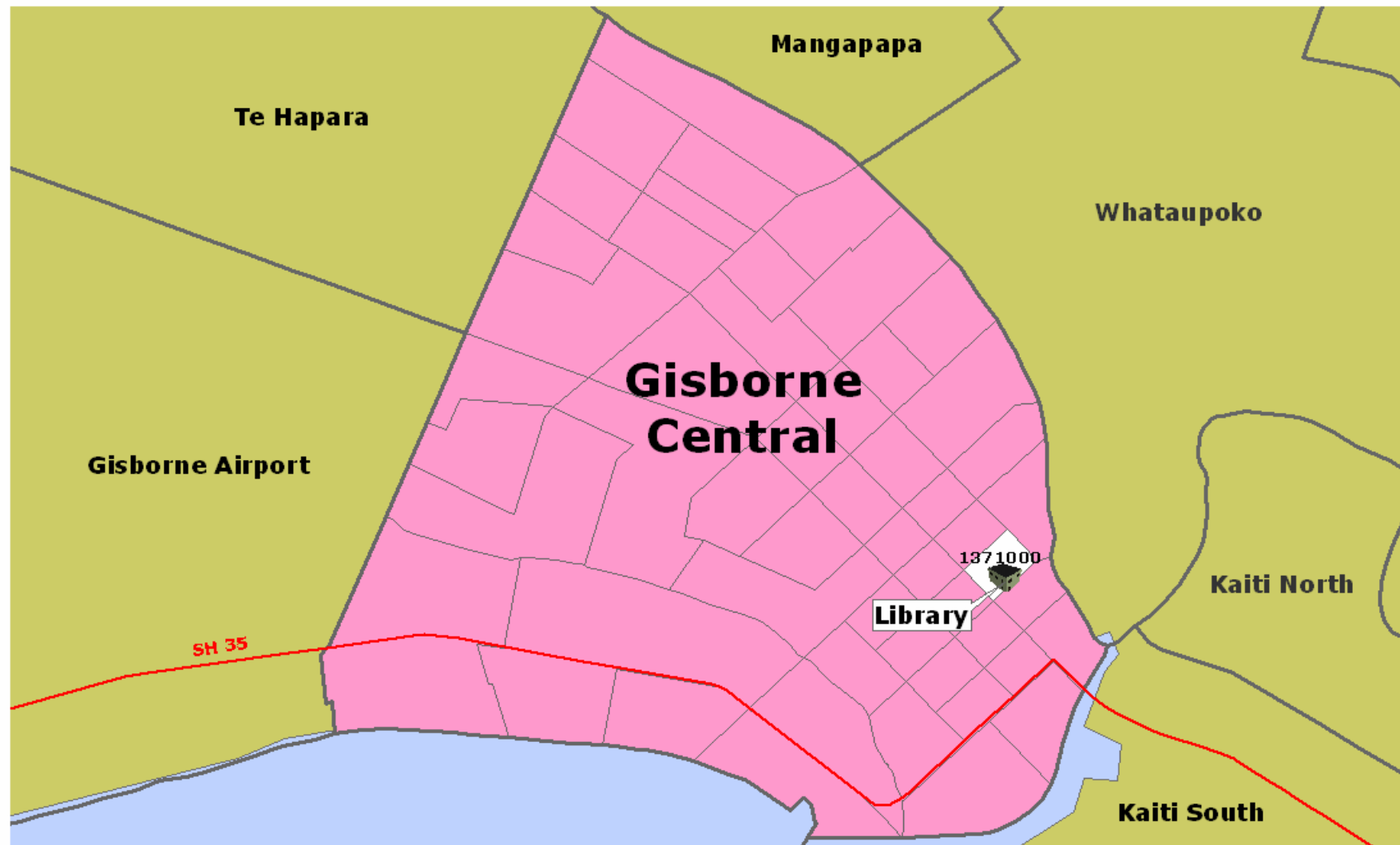

Meshblock

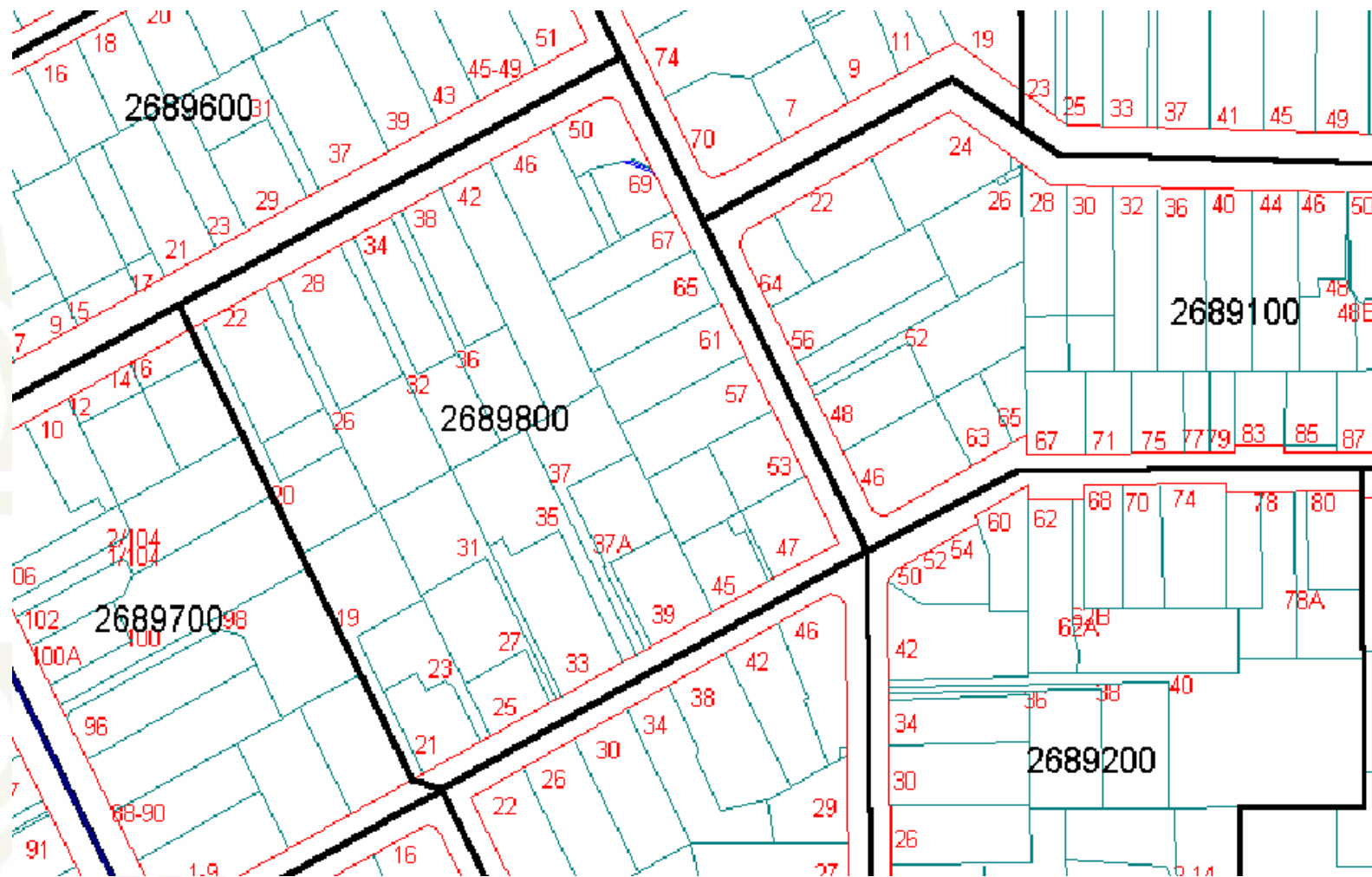

Resource for everyone

Business

Local government

Students

Community groups

Central government

Financial analysts

Statistical analysts

Sports clubs

Individuals

Iwi

Researchers

Academics

Emergency services

Charities

Journalists

Policy analysts

Census community stories



<http://www.stats.govt.nz/census/about-2006-census/census-community-stories/default.htm>

Census day – 7 March 2006

New Zealand Census of Population and Dwellings



Filing an census form is required by law. Census information is needed for planning in important areas such as education, health, housing, business planning and investment. It is also used to help us understand how our society changes over time.

The information you provide must be kept confidential by Statistics New Zealand and is protected by the Statistics Act 1975. Census information can only be used for statistical purposes.

The Public Records Act 2005 requires census forms be kept as historical records. After 100 years census forms may be made available for research that meets the confidentiality requirements of the Statistics Act.

Statistics New Zealand will also use census responses to select a small sample of people to participate in a survey on disability.

Thank you for taking part in this important census.

INTERNET ID: 6 7 9
ID digit: 0 3
PI Etw
Posted

For te reo Māori / English forms, call 0800 236 787

Individual Form

7 March 2006

for census on-line go to www.stats.census.govt.nz
call the Helpline toll-free on 0800 CENSUS (0800 236 787)

Elize Peck
Government Statistician

1 How to answer

- mark your answers like this:
- if you make a mistake, do this:
- print your answers in CAPITAL LETTERS like this: SHORTLAND STREET

2 What is your full name?

first names

family name

3 Are you?

- male
- female

Mark your answer like this:

4 When were you born?

day month year you were born (eg 30 (eg 05) (eg 1956))

5 Where do you usually live?

Students and overseas residents: see the Guide Notes for more information.

Print the full address of that dwelling. Give all of these, if possible:

street number flat number

street name

suburb or rural locality

city, town or district

country

6 How long have you lived at the address you gave in question 5?

- less than one year
- number of years

7 Where did you usually live 5 years ago on 7 March 2001?

- at the address I gave in question 6
- in New Zealand at another address. Print that address as fully as you can:

street number flat number

street name

suburb or rural locality

city, town or district

country

8 On the night of Tuesday 7 March, which address are you at?

- at the address I gave in question 6
- at another address. Print the address you are at including, if possible, all of these:

street number flat number

street name

suburb or rural locality

city, town or district

country

9 Which country was born in?

- New Zealand
- Australia
- England
- Scotland
- China (People's Republic)
- South Africa
- Samoa
- Cook Islands
- other: Please state of the country:

10 If you live in New Zealand, answer when did you first come to New Zealand?

month if known (eg 11)

11 Which ethnic group do you belong to?

- New Zealand
- Māori
- Samoan
- Cook Island
- Tongan
- Niuean
- Chinese
- Indian
- other such as TOKELAUAN

12 If you have given address in question 8, what is the type of dwelling?

- private dwelling in a motor camp
- hotel, motel, guest accommodation
- residential care for older people
- other non-private dwelling. Print what it is:

New Zealand Census of Population and Dwellings

7 March 2006

for census on-line go to www.stats.census.govt.nz
call the Helpline toll-free on 0800 CENSUS (0800 236 787)

Elize Peck
Government Statistician

Dwelling Form

7 March 2006

for census on-line go to www.stats.census.govt.nz
call the Helpline toll-free on 0800 CENSUS (0800 236 787)

1 How to answer

One person must fill in this brown Dwelling Form (either on paper or on the Internet), and ensure a blue individual Form is filled in (either on paper or on the Internet) for everyone here on census night. It is best if this is done by an adult who usually lives here.

- mark your answers like this:
- if you make a mistake, do this:
- print your answers in CAPITAL LETTERS like this: GRAND POND FLD

2 Print the full address of this dwelling. Give all of these, if possible:

street number flat number

street name

suburb or rural locality

city, town or district

3 How many blue individual Forms (either on paper or on the Internet) are being filled in, here in this dwelling?

These people fill in a blue individual Form, here in this dwelling:

- everyone, including babies, spending the night of 7 March here, and
- anyone who arrives on 8 March, who has not filled in a blue individual Form anywhere else. This includes babies.

How many altogether?

4 Mark the space that best describes this dwelling.

- house or townhouse (NOT joined to any other)
- house, townhouse, unit or apartment joined to one or more other houses, townhouses, units or apartments
- mobile dwelling, for example CARAVAN, BOAT, TRAVELER, etc.
- other. Print what it is:

5 Is this building as a whole:

- DON'T count as a separate storey:
- mezzanine floors
- split levels
- levels below ground

- one storey
- two or three storeys
- four or more storeys
- none of these

Go to the next page

Challenges in taking a census

- More diverse: ethnicity, age, dwellings
- Respondents are busier
- Growing expectations in terms of the amount of information that should be collected in the census
- Growing expectations of how the Government should interact with the public
- Respondents' reluctance to fulfil obligations
- Access: remote areas, gated communities, apartments, secure dwellings

Responses to changes

- Complemented traditional collection methods
- Stronger links with local government and communities
- Kaitakawaenga, Pacific Liaison Officers and other targeted strategies
- Uses and users are becoming much more diverse

Questionnaire changes for 2006

Cyclical topics

- Cigarette smoking
- Fertility – number of babies born

Classification changes

What we look like as a nation



Our census night population

1906



0.9 million

1956

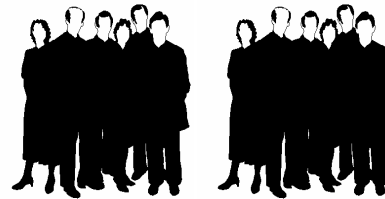

2.2 million

1976

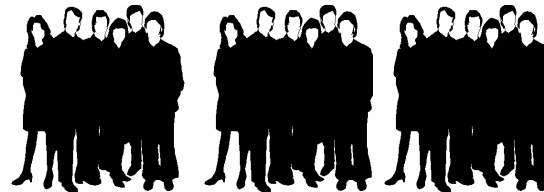

3.1 million

2006



4.1 million

Usually Resident Population

4,027,947

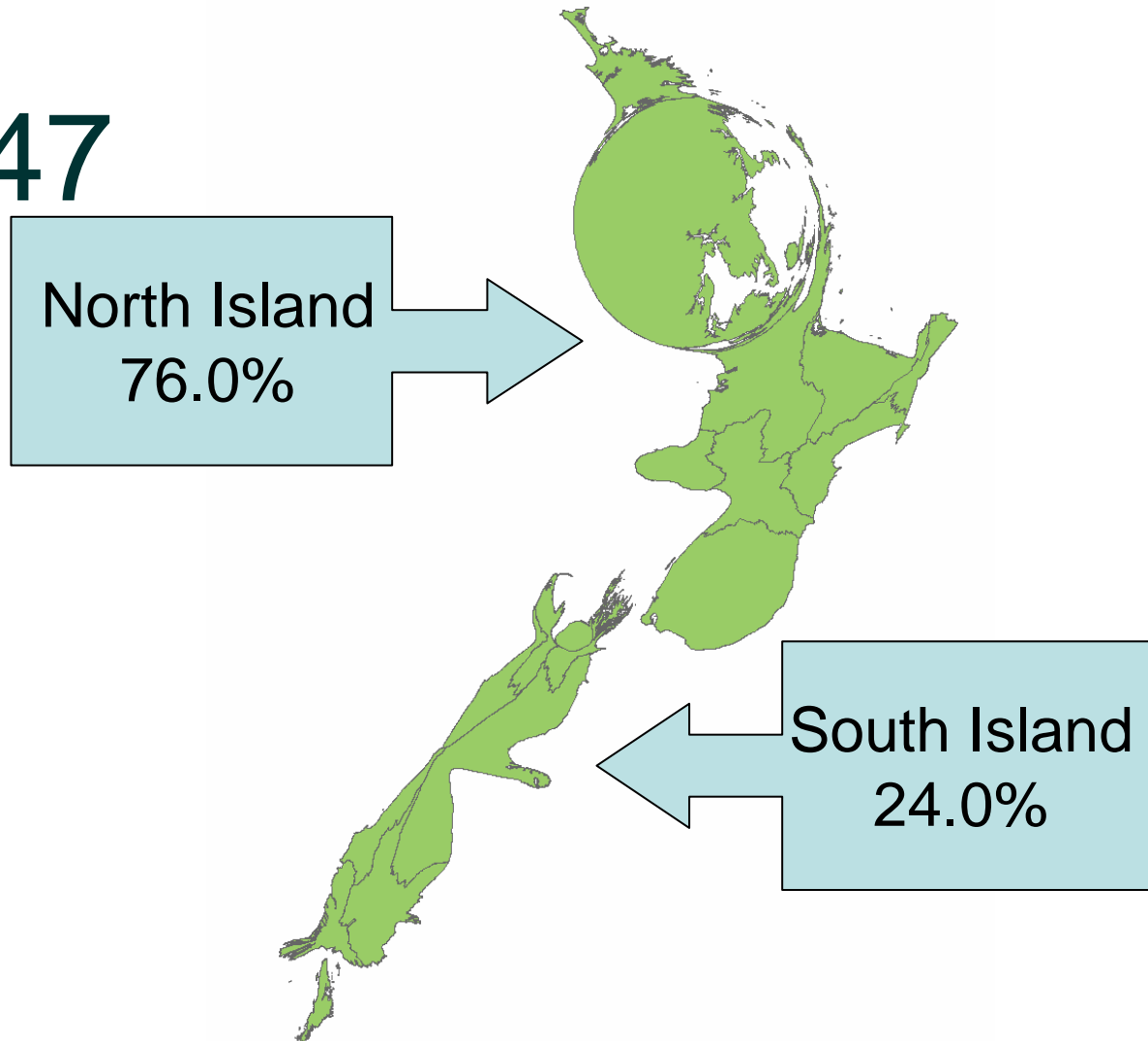

Change in the Usually Resident Population by Regional Council 2001 and 2006 Censuses

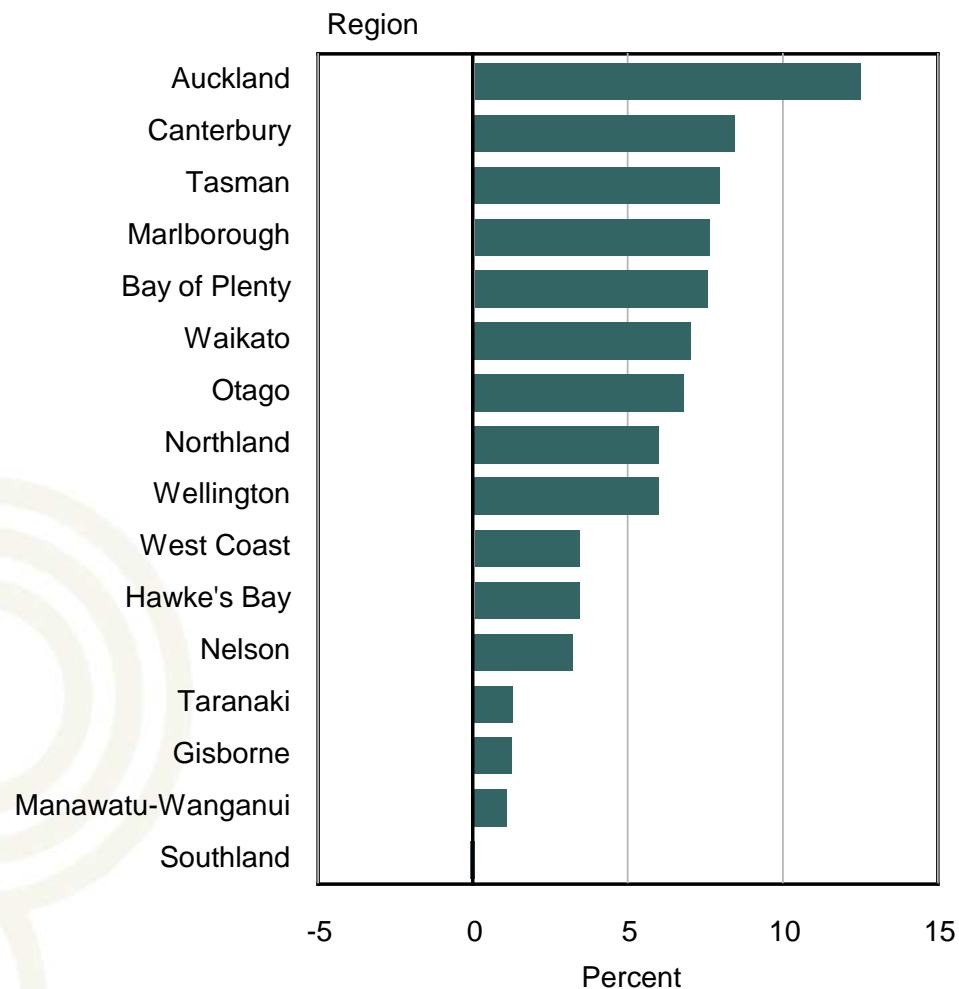

Age and Sex of Usually Resident Population

2006 Census

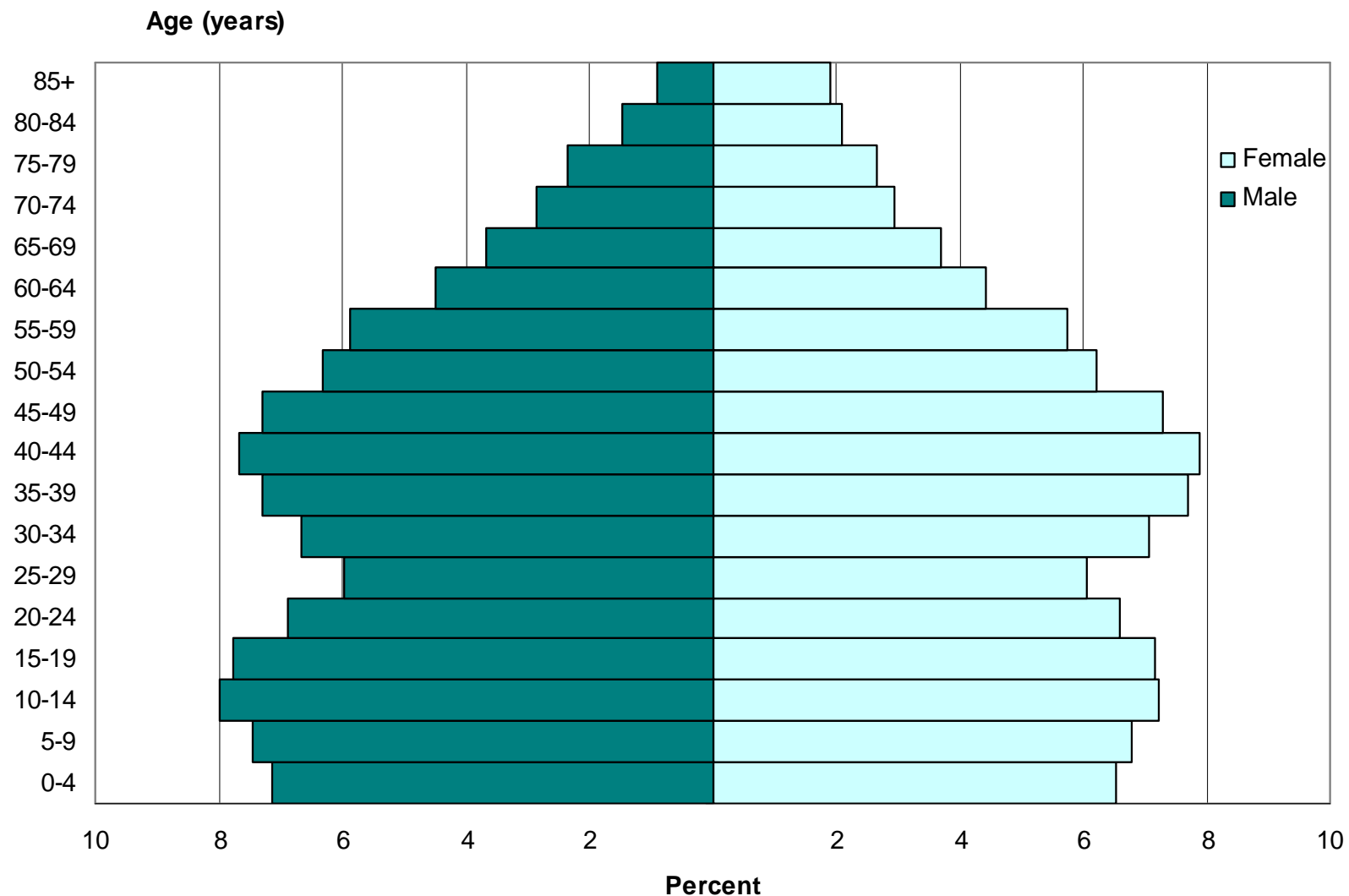

Ethnicity

People can identify as more than one ethnicity on their census forms, meaning the percentages add up to more than 100.

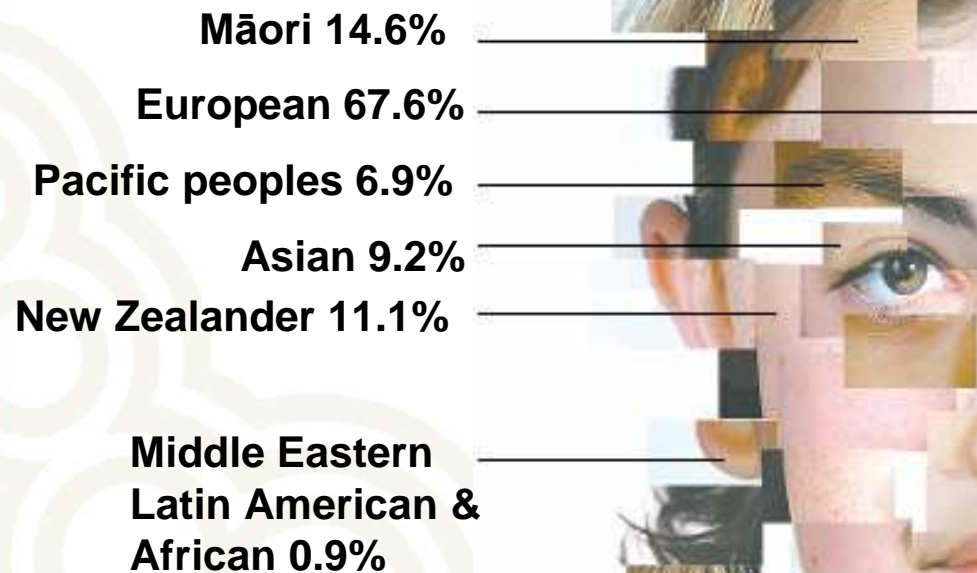

Picture source:
Dominion Post

Around one in 10 people identified with more than one ethnic group

Overseas born

- 879,543 usual residents were born overseas
- A third of people born overseas live in the Auckland region

Five most common overseas birthplaces in 2006

- | | |
|-------------|---------|
| • England | 202,401 |
| • China | 78,117 |
| • Australia | 62,634 |
| • Samoa | 50,649 |
| • India | 43,344 |



Languages spoken

Five most commonly spoken languages after English

• Māori	157,110
• Samoan	85,428
• French	53,757
• Hindi	44,589
• Yue (Cantonese)	44,154

Number of Children Born Alive per-Woman

1996 and 2006 Censuses

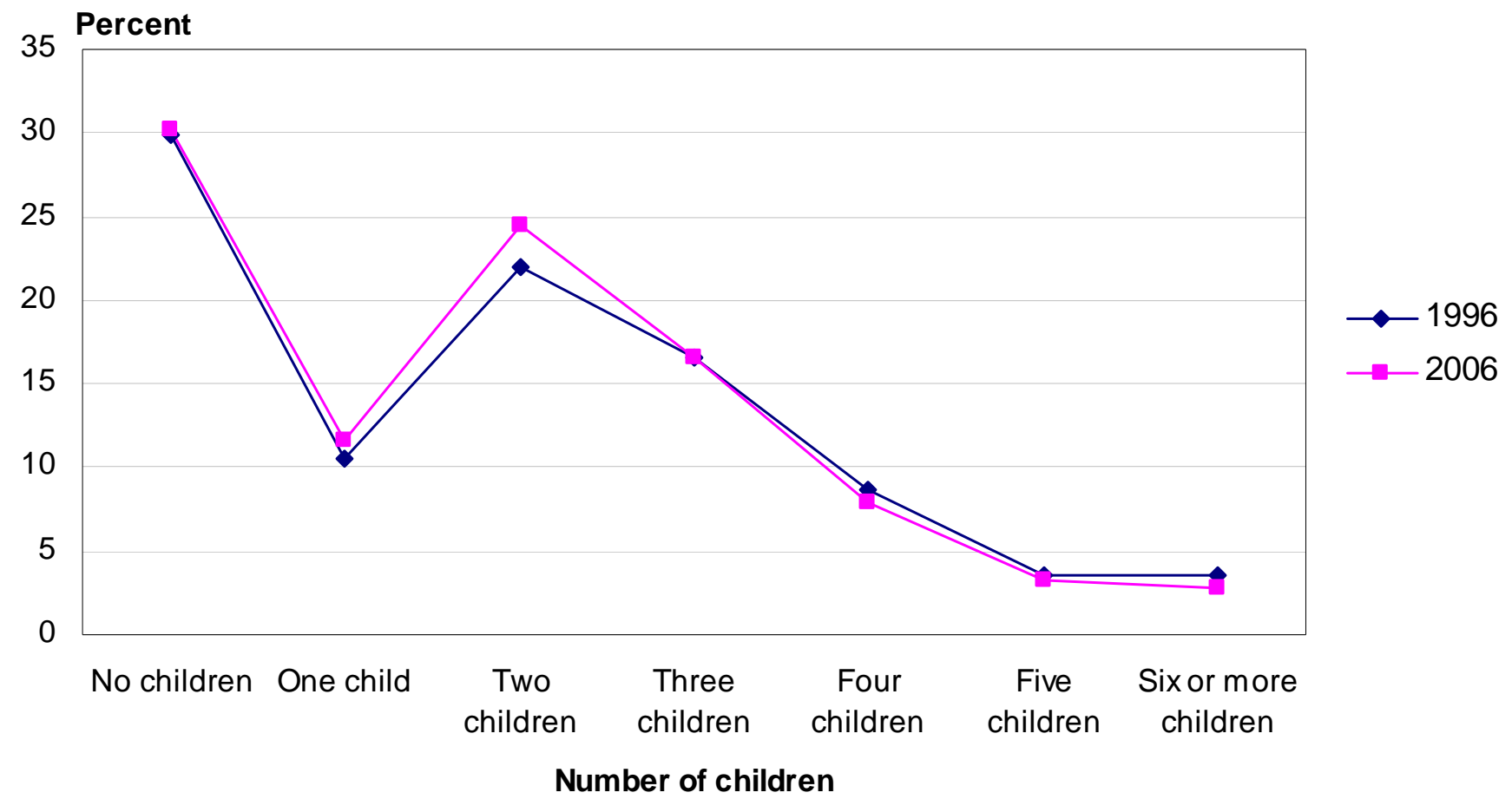

Cigarette Smoking Status

1996 and 2006 Censuses

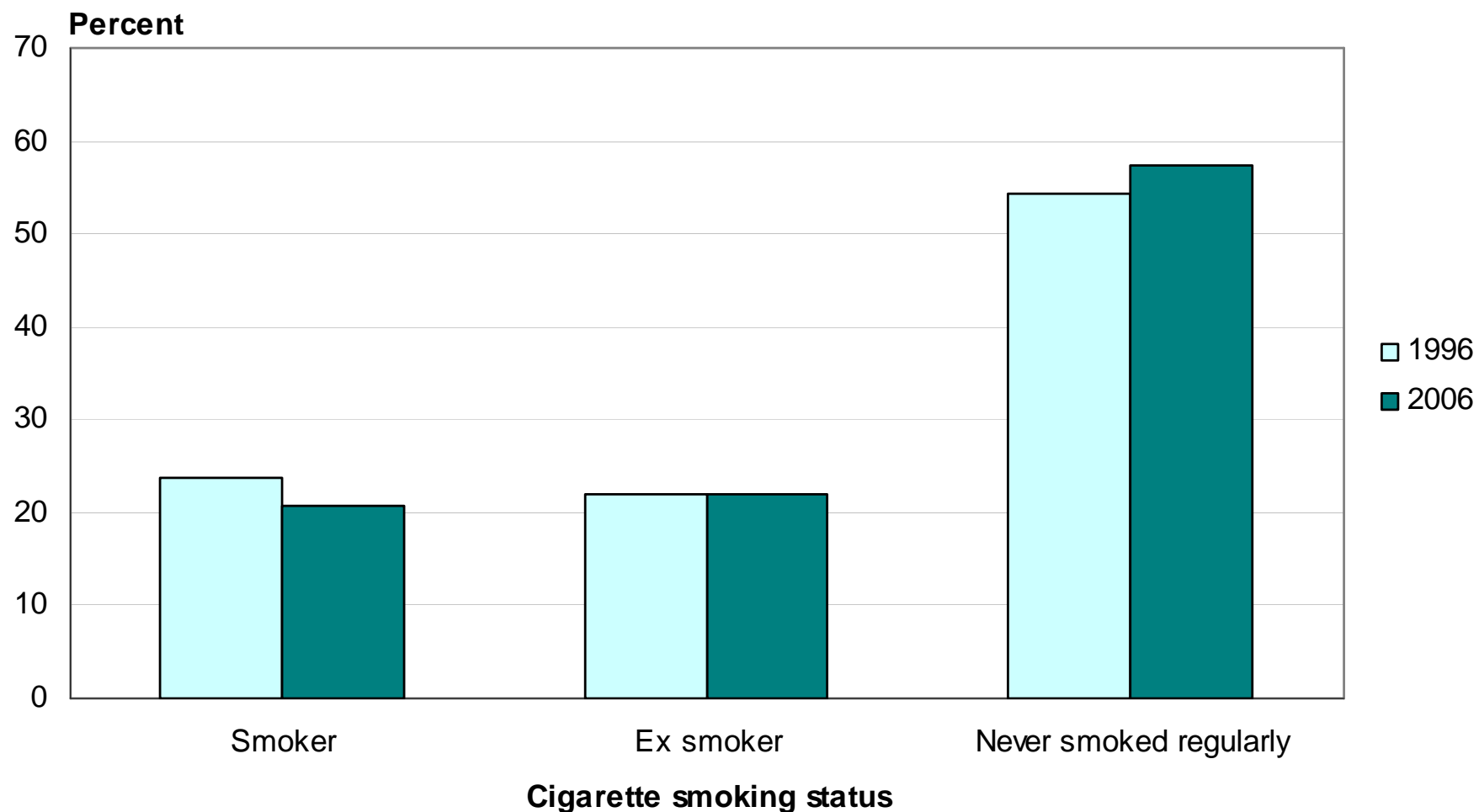

Annual Personal Income by Sex

2006 Census

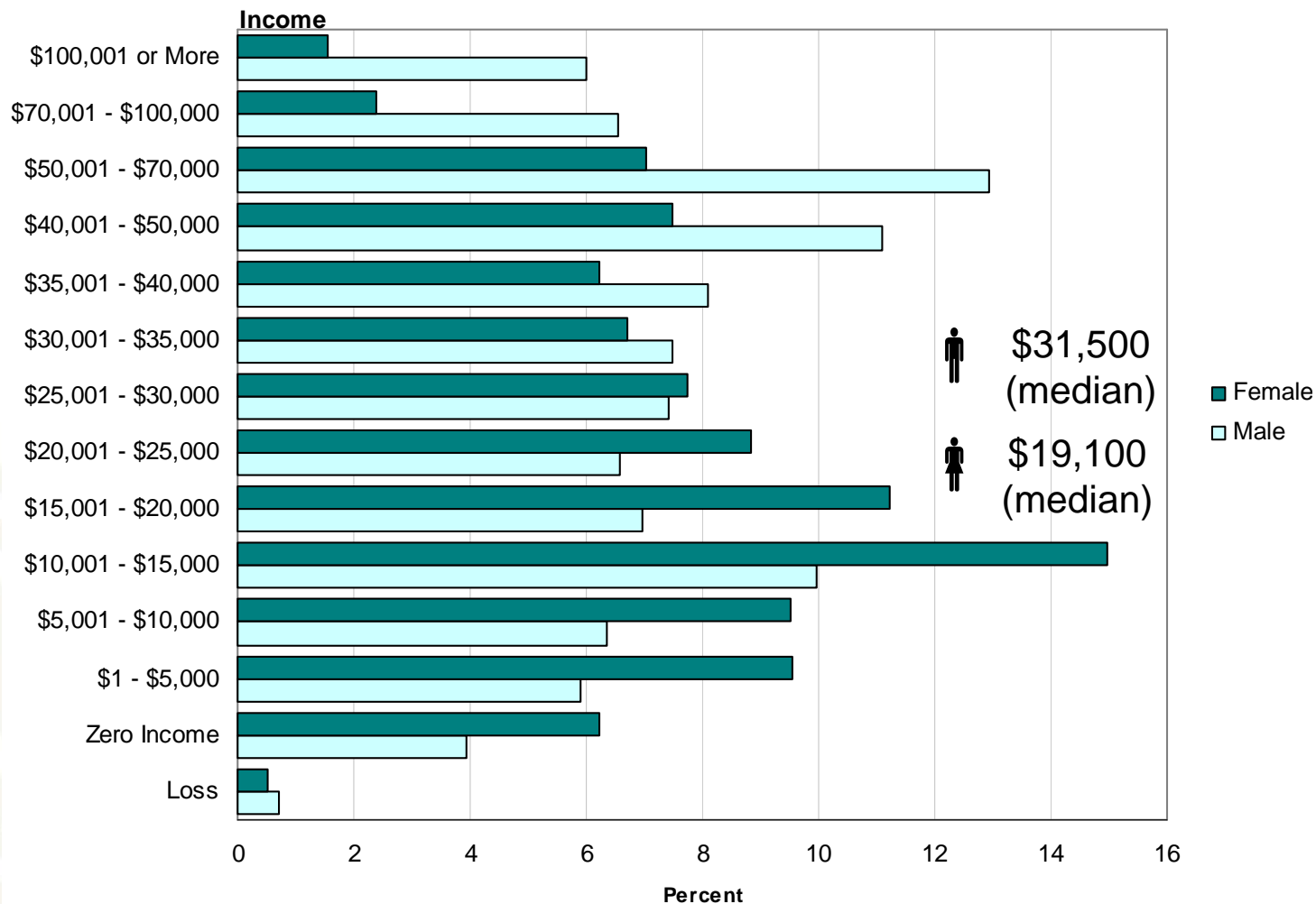

Occupations with Greatest Increase and Decrease 2001–2006 Censuses

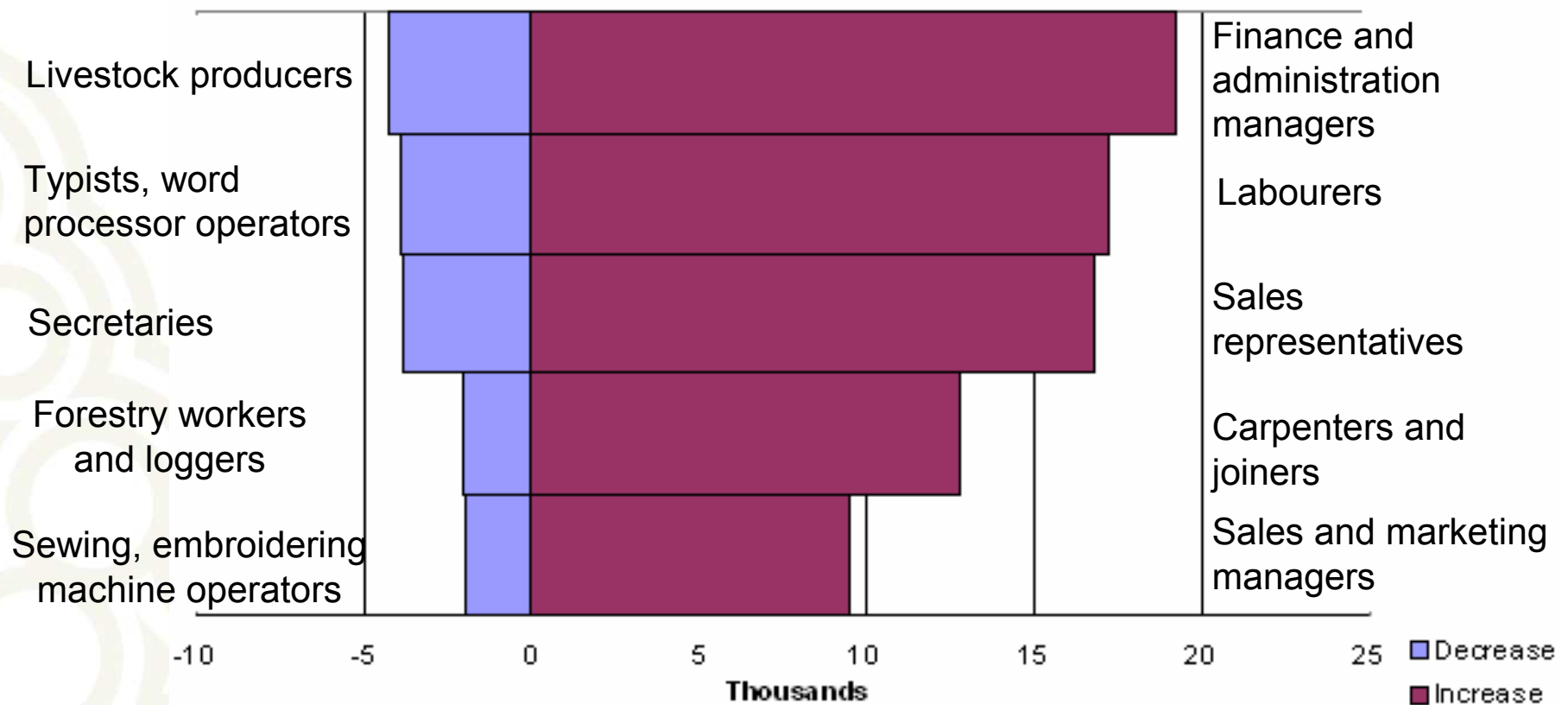

Households

- One-family households 69.1%
- Two or more family households 2.8%
- Other multi-person household 5.1%
- One-person households 23.0%

Household Access to Phones, Internet and Fax 2006 Census

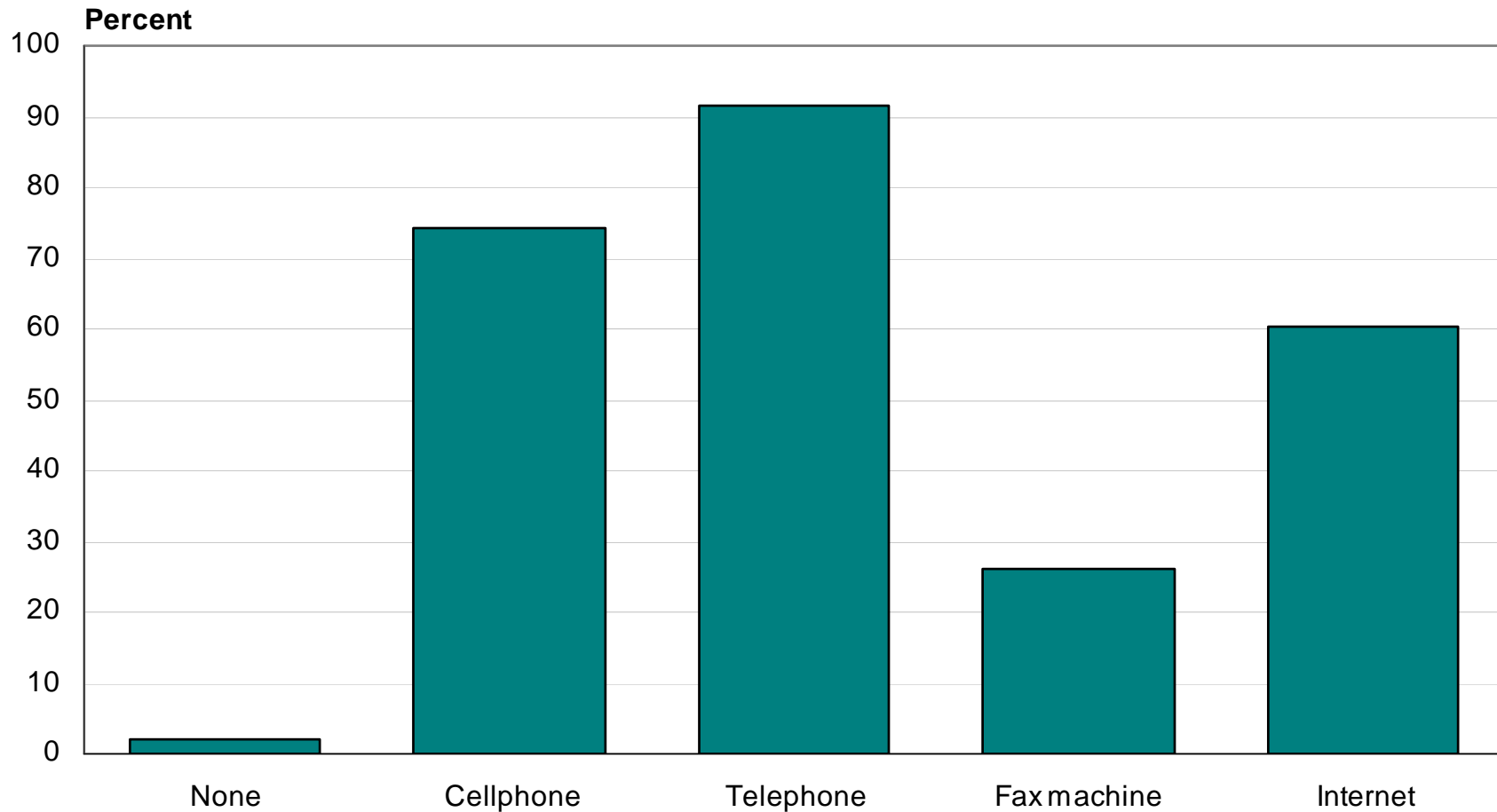

Ownership of Dwelling

1991 – 2006 Censuses

